

ORIGINAL USER MANUAL

DFP5X

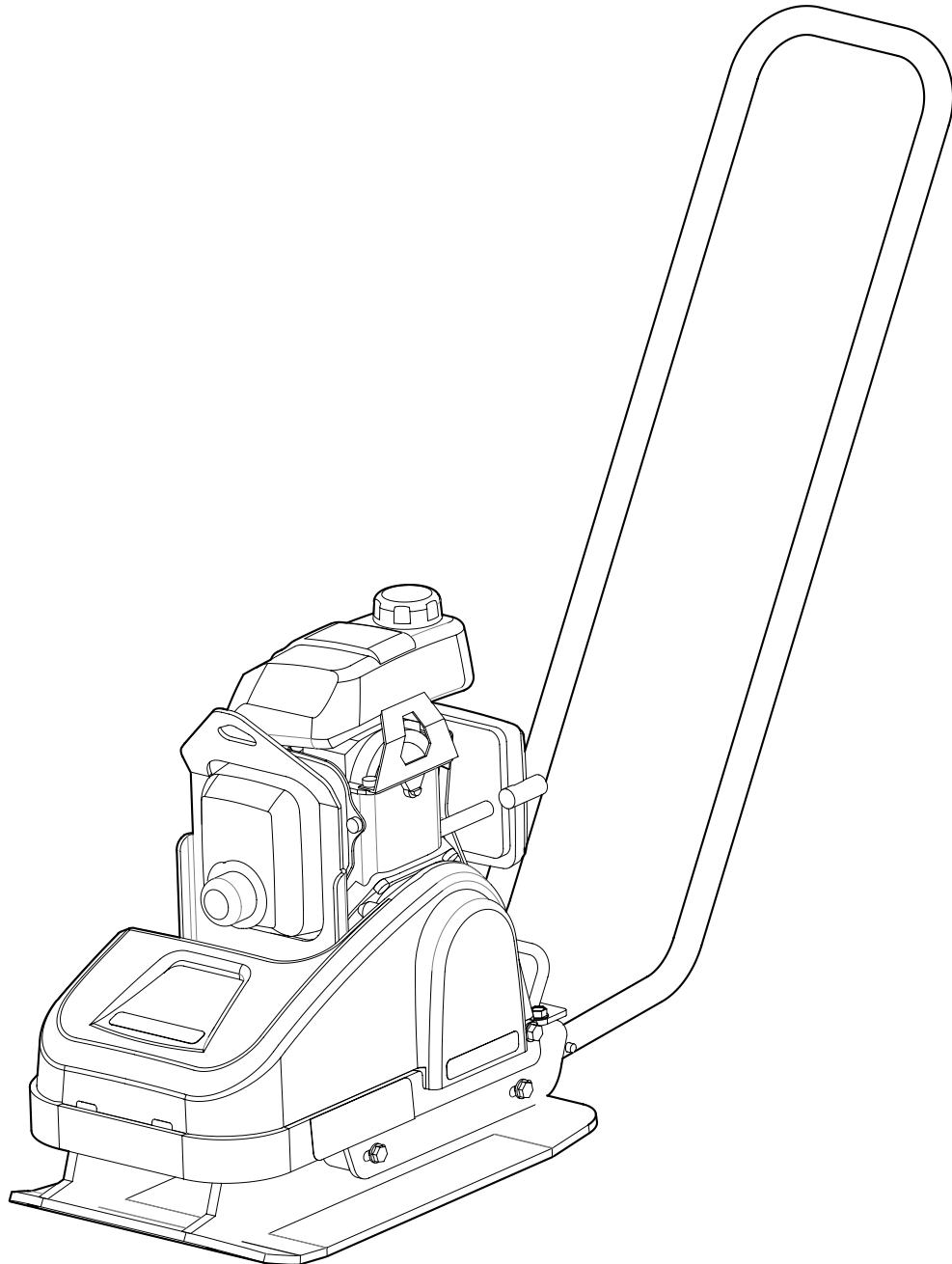

DFP5X

is used to pack gravel and sand for minor construction work, such as preparing the substrate for concrete blocks or paving stones for gardens. The machine's compact design allows good accessibility in tight spaces.

CONTENTS

USE	3
SAFETY INSTRUCTIONS.....	4
STANDARDS	4
SIGNS	5
TECHNICAL DATA.....	6
FUNCTION	6
TECHNICAL DESCRIPTION	7
DAILY CHECKS	8
BEFORE STARTING GX 120 ENGINE	9
STARTING	9
AFTER STARTING.....	9
STOPPING	9
DIMENSIONS.....	10
TRANSPORT.....	11
NOTES.....	12; 13; 14
EC DECLARATION OF CONFORMITY.....	15

SAFETY INSTRUCTIONS

- Before using the machine, the operator must be familiar with the manufacturer’s safety instructions and instructions for use.
- The machine must only be used outdoors.
- The machine must never be used if protection and safety devices are not present or not working.
- The operator must never leave the machine unattended when the engine is on. When the vibrator is connected, the operator must be able to control the movement of the machine using the control handle and the start/stop controls. The machine must be operated only by a trained operator.
- During maintenance or other work on the machine, the engine must always be off.
- Switch the engine off before adding fuel. Avoid fuel spillage and immediately wipe off any spilled fuel. Add fuel only in well-ventilated areas.
- Never touch hot engine parts, such as the muffler.
- Before lifting the machine, check that the lifting device and its mounting are not damaged and that the rubber dampers on the base plate are undamaged and tightened.
- During transport and storage, the fuel tank should be empty and the fuel valve switched off.
- The operator must use ear protection when working with the machine.
- The operator must ensure that no unauthorized people are in the immediate vicinity of the machine.
- Always wear personal protective equipment, such as heavy, non-skid shoes, ear protection and approved eye protection.
- The machine must never be used in environments with potential fire or explosion hazards.
- Never use the machine if you are tired, have consumed alcohol or are taking medication that could affect your vision, thought or your coordination.
- Use the machine only for the purpose for which it was designed.

STANDARDS

Noise

Measurement in accordance with standard EN 500-4 Rev. 1:1998, Appendix C:
 Measurement uncertainty ± 0.5 dB (A) in 95% of the measurements.
 In accordance with the conditions in Directive 2000/14/EC, Appendix VI, the following values are reported:

	DFP5X
Sound pressure level at the operator’s ears, L _{pA}	89 (A) L _{pA}
Permitted sound power level, L _{WA}	105 dB (A)
Guaranteed sound power level, L _{WA}	105 dB (A)

Because the sound pressure level at the operator’s ears exceeds 80 dB (A), ear protection must be used during operation!

Hand/arm vibration

The vibration acceleration was measured according to standard ISO 5349 during operation on a gravel surface. The measurement values were converted to the maximum daily exposure time for regular usage. For more information about vibration, please refer to regulation AFS 2005:15 from the Swedish Work Environment Authority, effective July 1, 2005.
 Measurement uncertainty ± 0.3 m/s² in 95% of the

DFP5X	Metric	Imperial
Hand/arm vibration	4.5 m/s ²	14.7 ft/s ²
Maximum daily exposure time	2.5 hours	

Exhaust emissions

DFP5X meets the requirements of U.S. EPA EXH/EVP AND CALIFORNIA SORE EXH/EVP REGS FOR 2019

SIGNS

Warning signs

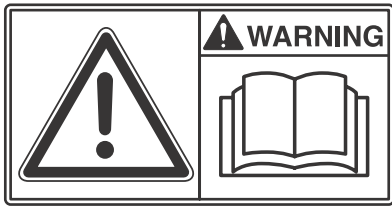

Before use, carefully read the manual and its safety instructions so that you can handle the machine safely. Make sure the manual is always accessible.



Engine, muffler: To avoid burns or discomfort, do not touch hot engine parts when the engine is on or when the machine has recently been used.



Belt drive: Keep hands, tools and other objects away from the belt drive when the machine is on to avoid injury and damage. See the safety instructions in the manual.



As the sound pressure level at the operator's ears exceeds 80 dB (A), ear protection must be used when working with the machine to prevent hearing damage.

SAFETY INSTRUCTIONS

WARNING: Breathing diesel engine exhaust exposes you to chemicals known to the State of California to cause cancer and birth defects or other reproductive harm.

- Always start and operate the engine in a well-ventilated area.
- If in an enclosed area, vent the exhaust to the outside.
- Do not modify or tamper with the exhaust system.
- Do not idle the engine except as necessary.

For more information go to www.P65warnings.ca.gov/diesel.

WARNING: Crude oil, gasoline, diesel fuel, and other petroleum products can expose you to chemicals including toluene and benzene, which are known to the State of California to cause cancer and birth defects or other reproductive harm.

These exposures can occur in and around oil fields, refineries, chemical plants, transport and storage operations, such as pipelines, marine terminals, tanker trucks, and other facilities and equipment.

For more information go to: www.P65Warnings.ca.gov/petroleum



Machine signs

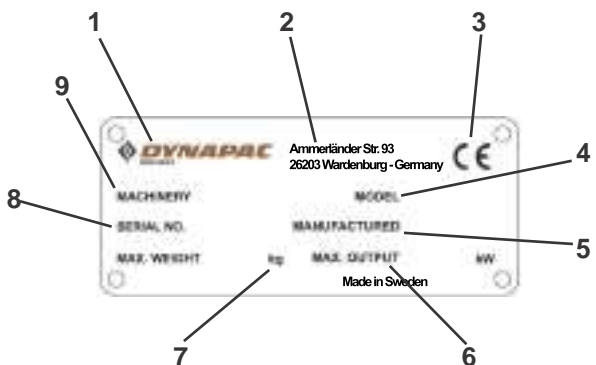

1. Manufacturer
2. Place, production country.
3. CE mark.
4. Model name.
5. Production year.
6. Max. engine power.
7. Max. weight.
8. Serial number.
9. Machine type

TECHNICAL DATA

DFP5X	Metric	Imperial
Net weight	52 kg	114.6 lbs
Base plate, w x l	300 x 500 mm	11.8 x 19.6 in
Speed	25 m/min	82 fpm
Centrifugal force	9 kN	2023.2 lbs
Vibration frequency	115 Hz	6900 vpm
Drive engine	Honda GXR120	
Engine power	1.8 kW	2.4 hp
Engine RPM	3500 RPM	
Fuel tank volume	0.77 liters	0.20 gal
Fuel type	Unleaded gasoline or alkylate	
Oil quantity, crankcase	0.4 liter	0.1 gal

FUEL AND OIL RECOMMENDATIONS

FuelUnleaded gasoline or alkylate
 Engine oilSAE10W-30
 Engine oil change: first oil change after 20 hours then every 100 hours of operation

FUNCTION

The machine consists of a base plate with a vibration element and an upper part cushioned from the base plate. The power is transmitted from the gasoline engine to the vibration element by a V-belt. The engine has an integrated centrifugal clutch. Due to the direction of rotation and the position of the vibration element at the front end of the base plate, the vibrator moves forward under its own power. The moving parts are well protected by a cover made of impact-resistant ABS.

TECHNICAL DESCRIPTION

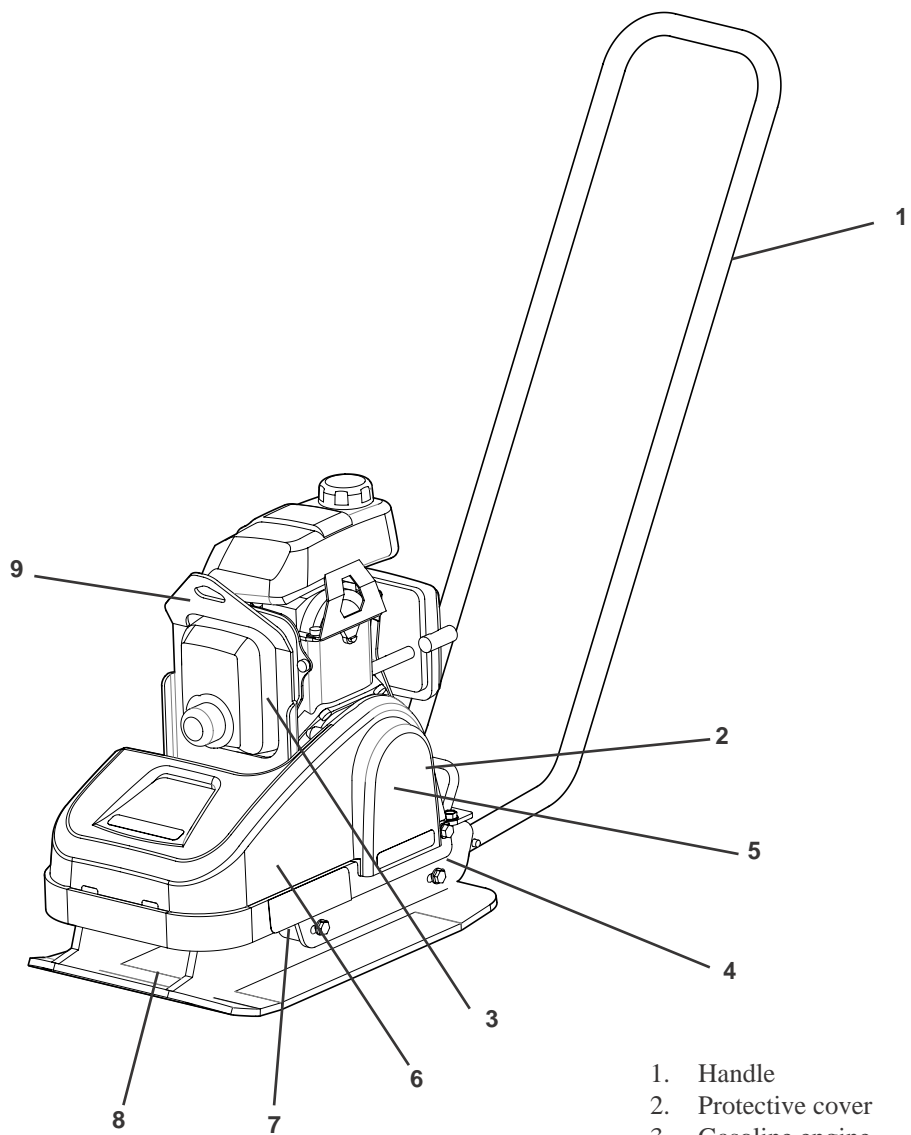

- 1. Handle
- 2. Protective cover
- 3. Gasoline engine
- 4. Engine plate
- 5. Centrifugal clutch
- 6. V-belt
- 7. Rubber damper
- 8. Vibration element / Base plate
- 9. Lifting lug

DAILY CHECKS

Fuel check

Check that there is fuel in the tank. Top up if necessary.

Engine oil level check

Check the oil level in the crankcase every day. The oil must reach the edge of the filling hole when the machine is on a level surface.

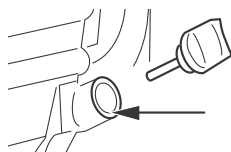

Air filter check

The air filter must be checked at least once every working week. When working in dusty conditions, check daily.

- 1. Paper element
- 2. Foam plastic element

Cleaning the air filter

- 1. Remove the foam plastic element and the paper element and check that they are undamaged. Replace damaged parts.
- 2. Wash the foam plastic element in liquid with a high flash-point and let it dry properly. Dip in engine oil and squeeze dry.
- 3. Strike the paper element against a hard object a few times to loosen any dirt.

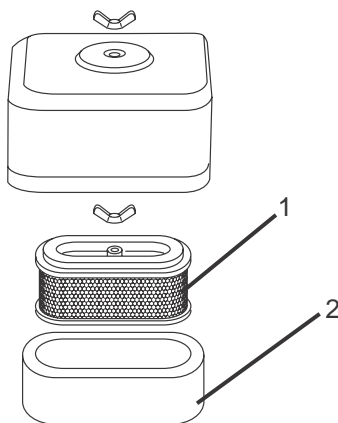

Oil/fuel leakage

Check every day that the engine is not leaking oil or fuel. If a leak is discovered, the machine must not be operated until the leak has been fixed.

Also see the separate engine manual!

V-belt drive

Check the tension and condition of the V-belt regularly. Replace a damaged V-belt with the new type **XPA 907**.

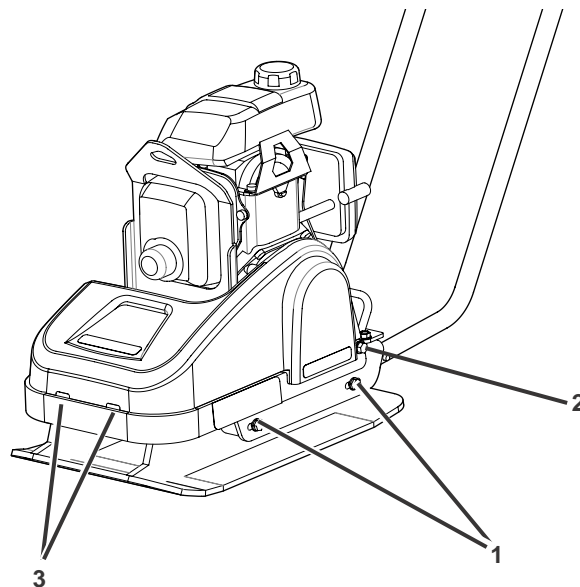

Adjusting the V-belt tension

Loosen the screws (pos. 1) that hold the engine plate. Loosen the screws (pos. 2) that hold the cover. Remove the cover.

Tension the V-belt by pulling the handle on the side of the engine plate. Tighten the screws. Reinstall the cover.

Rubber dampers

Check the condition of the rubber dampers (pos. 3) regularly. Replace damaged dampers.

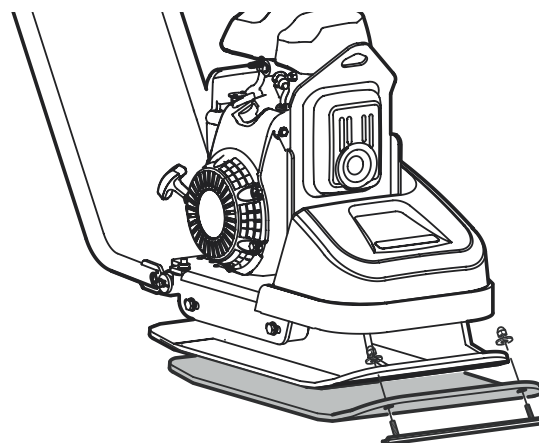

Polyurethane pad

A polyurethane pad is used for stone paving work to protect against stones and ground clinker.

Note! accessories

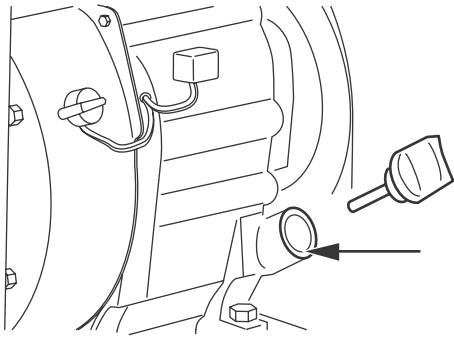

Oil level

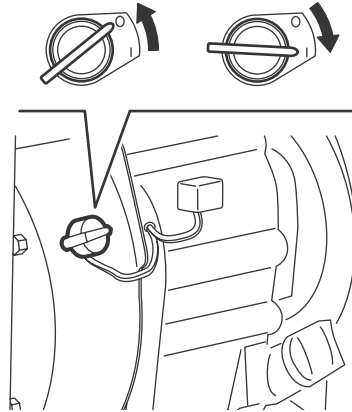

Engine power switch

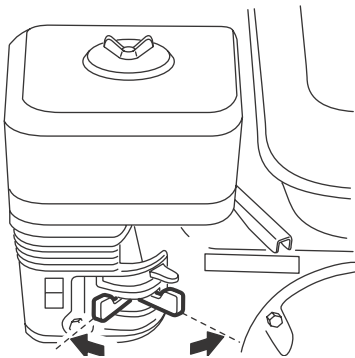

Off On
Fuel valve

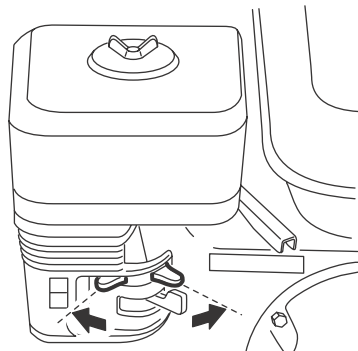

Active Not active
Choke

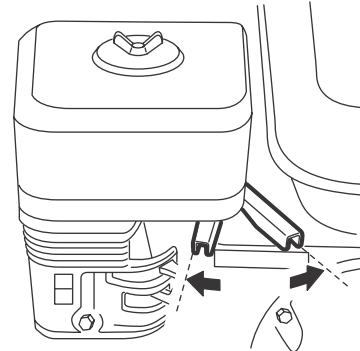

Full RPM Idle
Throttle lever

BEFORE STARTING THE ENGINE

See the daily checks on page 8.

STARTING

Turn the engine power switch to “on”. Open the fuel valve.

See that the lever is in idle position.

Activate the choke. If the engine is cold, activate the choke completely. Do not use the choke if the engine is warm or if the air temperature is high.

Start by pulling the starting handle. First pull it until the mechanism engages. Then pull it hard and fast.

AFTER STARTING

Switch the throttle lever to idle.

Open the choke gradually.

Run the engine warm for around 1–5 minutes.

STOPPING

Switch the engine to idle and let it run for a few minutes.

Switch the engine power switch to “off”.

Close the fuel valve.

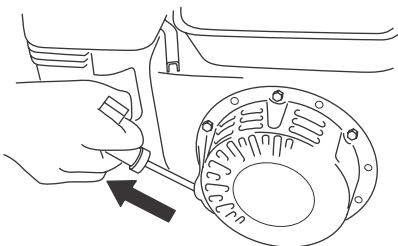

DIMENSIONS in mm

Dimensions

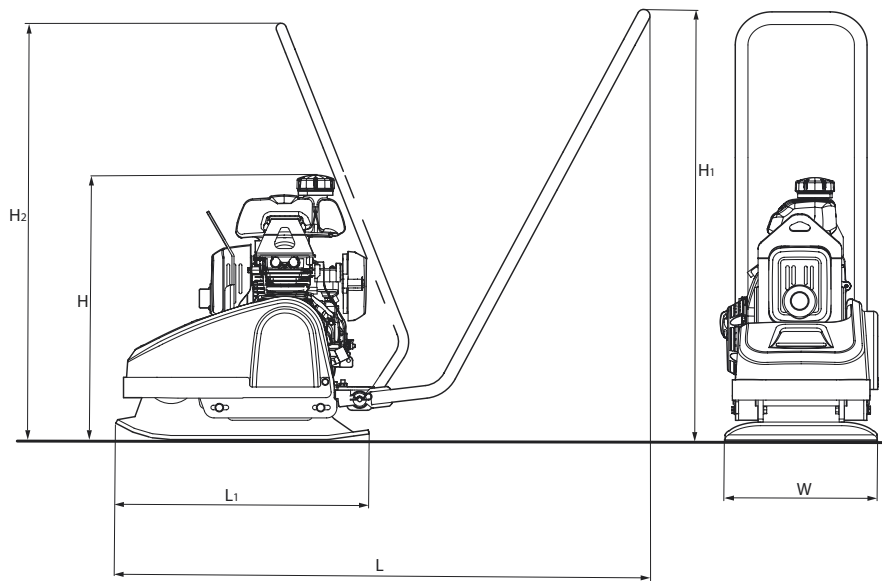

	Metric	Imperial
H	520 mm	20.4 in
H ₁	870 mm	34.2 in
H ₂	840 mm	33 in
L	1110 mm	43.7 in
L ₁	500 mm	19.6 in
W	300 mm	11.8 in

TRANSPORT

It is easy to remove the handle without tools, and the trunk of a standard car is big enough to transport the machine.

Lifting by hand

Remove the handle by pushing it forward and pull apart the shafts so that the fastening tabs release.

Move the handle slightly sideways so that the handle releases.

Caution! The machine must be lifted by 2 people!

Lift by the handle on the back and the front edge of the machine.

Lifting with a crane

Tilt the handle forward.

Attach a lifting sling to the lifting hook and thread the lifting sling between the shafts of the handle, see illustration below.

Lifting hook

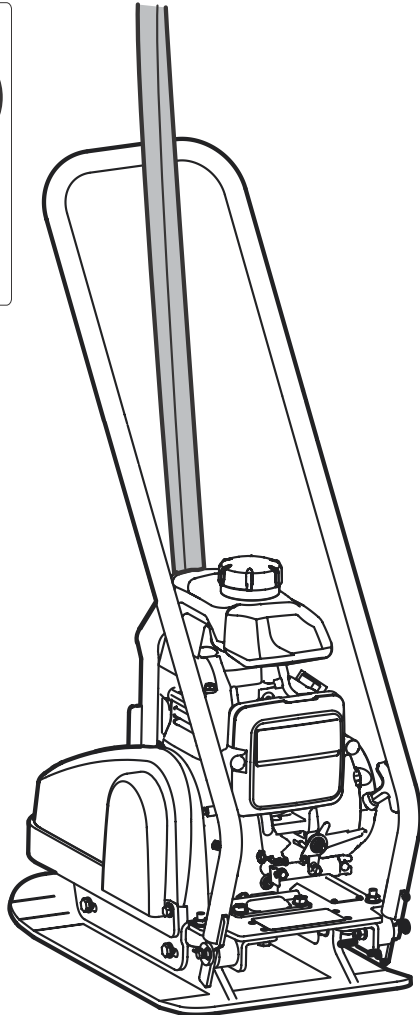
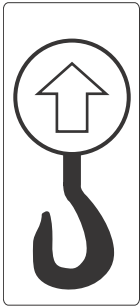
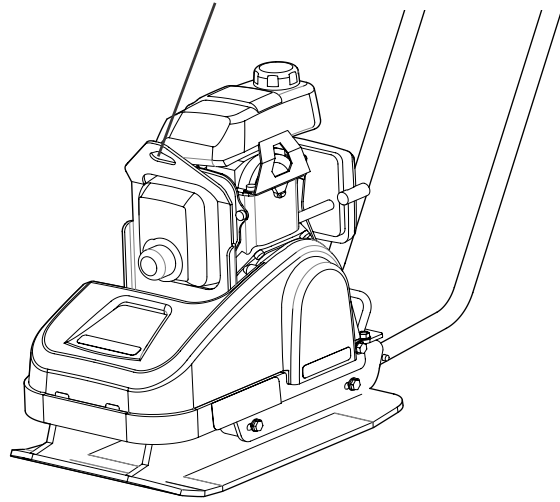

Securing for transport

Secure the machine with straps according to illustration during transportation.

Note! Secure it by the base plate and not by the rubber-cushioned upper part.

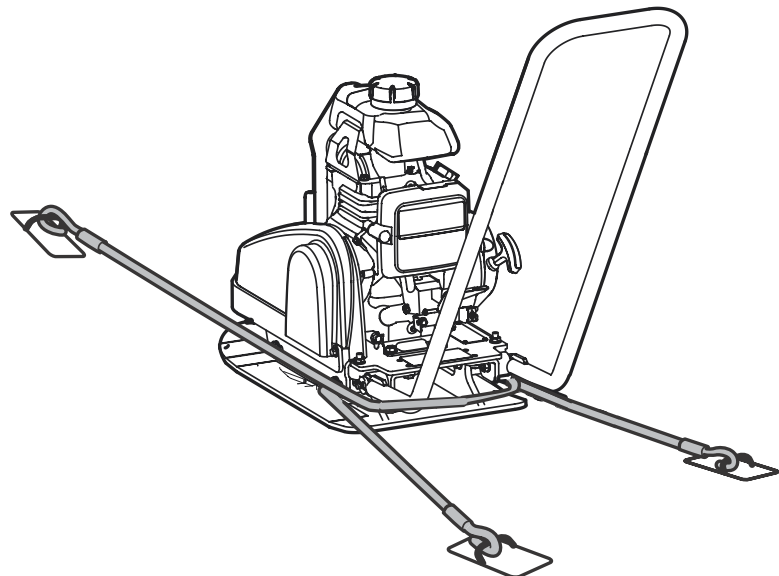

NOTES

NOTES

NOTES



Declaration of conformity

Manufacturer

**Dynapac GmbH
Ammerländer Str. 93
26203 Wardenburg, Germany**

1. Category: Vibration plate

2. Type: DFP5X

3. Engine power: 1.8 kW

The product complies with the following directives:

2006 / 42 / EC

2000 / 14 / EC

2004 / 108 / EC

EN 500-1

EN 500-4

Technical documentation held by:

Dynapac GmbH, Ammerländer Str. 93 26203 Wardenburg, Germany
Jens Praesang / Team Leader Technical Documentation

